

Country Hospital Nurses' Residence



The former Mount Morgan Hospital Nurses' Quarters (built c 1946) have been donated to the Australian Country Hospital Heritage Assoc. to use as a museum building for their collection of health services memorabilia.

The building was cut into sections, transported from Mt Morgan to Rockhampton's Heritage Village and reassembled. The building now has a new roof, new stumps, stairs and a handicapped access ramp.

After being refurbished internally it will be set up with displays to simulate the operation of an early 20th century hospital (<http://www.achha.org.au>).

The construction is similar to many Queensland country town public buildings of the era: timber with iron roof, louvered windows, verandah, etc. Stump height varies with the topography, often allowing a near-ground level entrance on a sloping site.

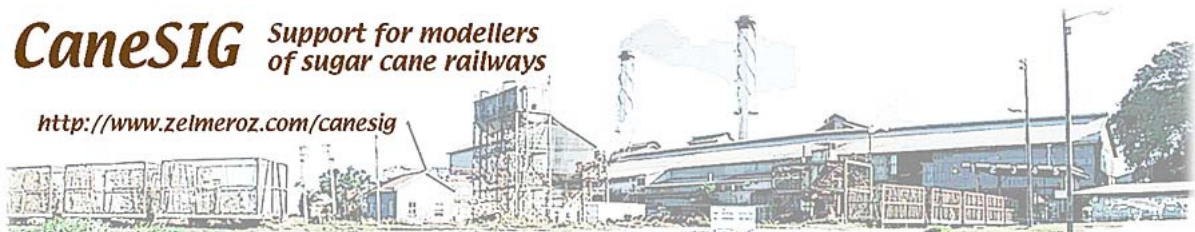

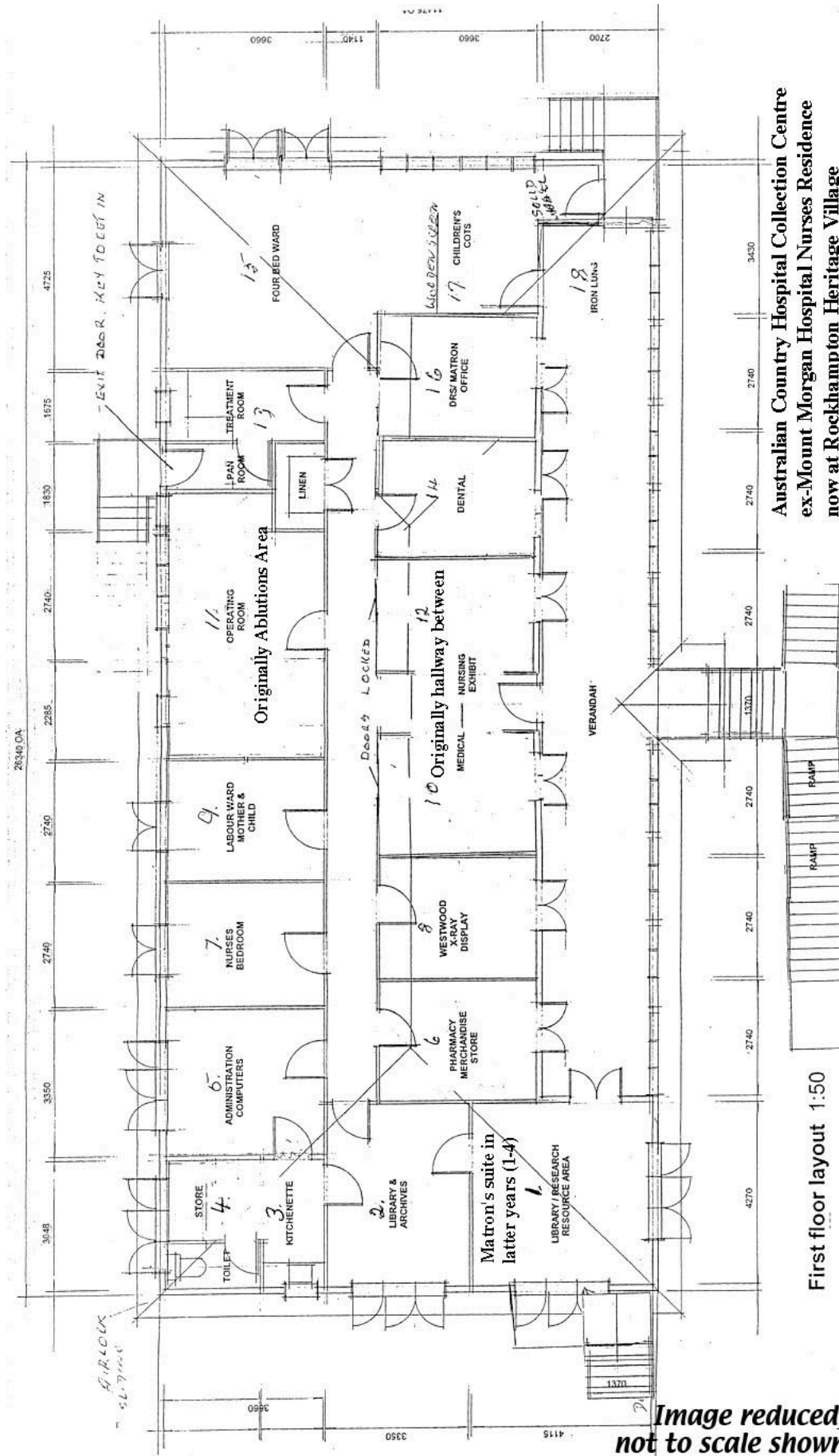

Australian Country Hospital Collection Centre
 ex-Mount Morgan Hospital Nurses Residence
 now at Rockhampton Heritage Village

First floor layout 1:50

Image reduced,
 not to scale shown