

~30' wide, 18' deep; inside wall height 11'; doors 6' wide x 7' 6" high; windows 5' 10" high x 2' 10" wide; platform side, left hand deck, 3' 11" wide; platform side, left hand door hinged, all other sliding; roof truss every 6' with stringers running length 4' o/c?; drip guard over windows; nominal roof peak (curve) 5' 0" above wall.

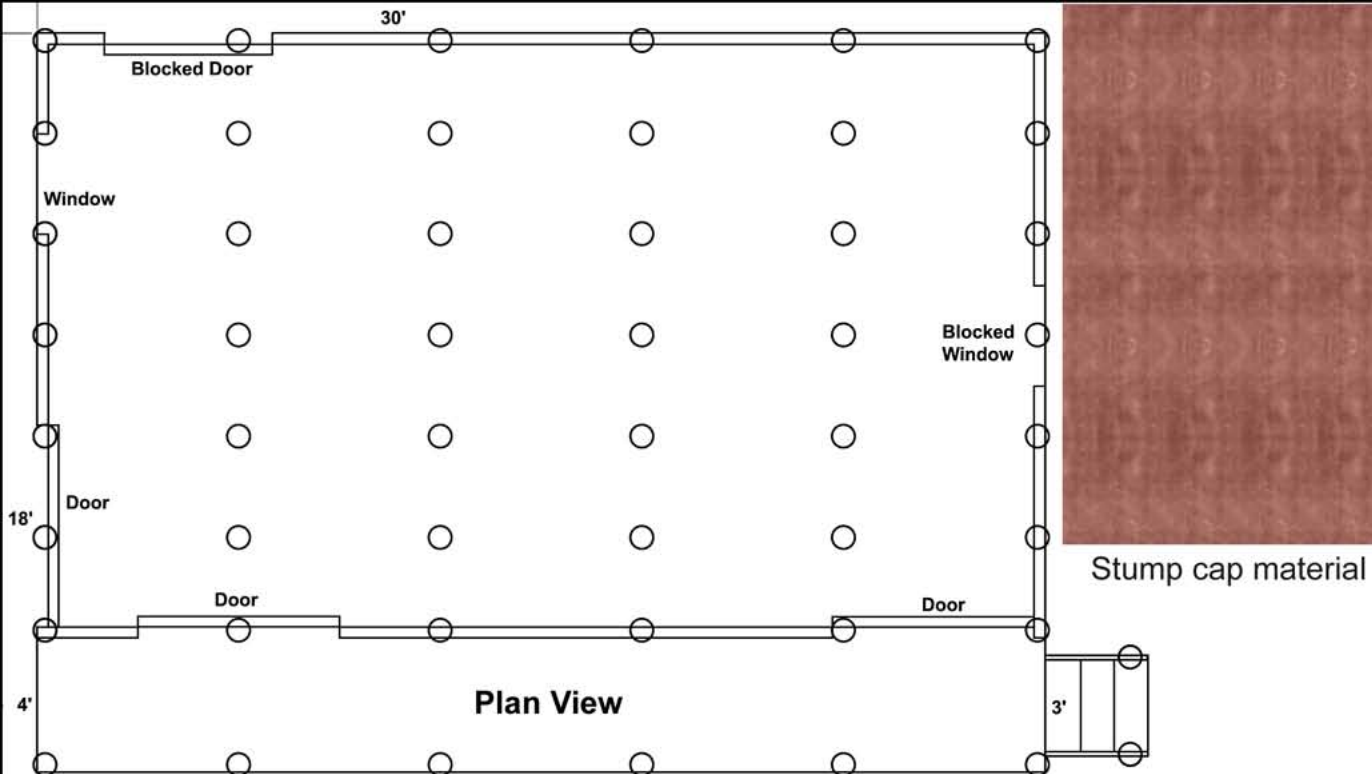

Stumps: Cut to height for your location, curl around 1/8" or smaller dowel and glue loose end.
Stump caps may be round (hole punch) or square and larger than stump diameter.

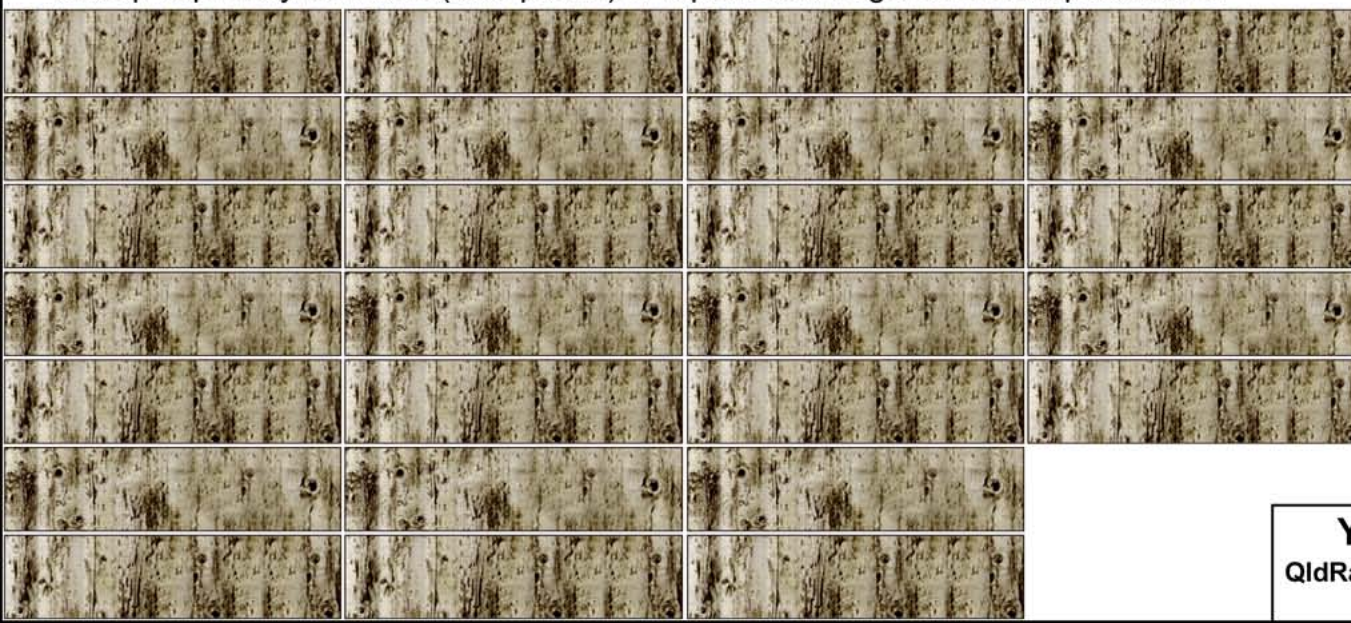

Care must be taken in assembly to ensure the structure aligns properly with the platform module.

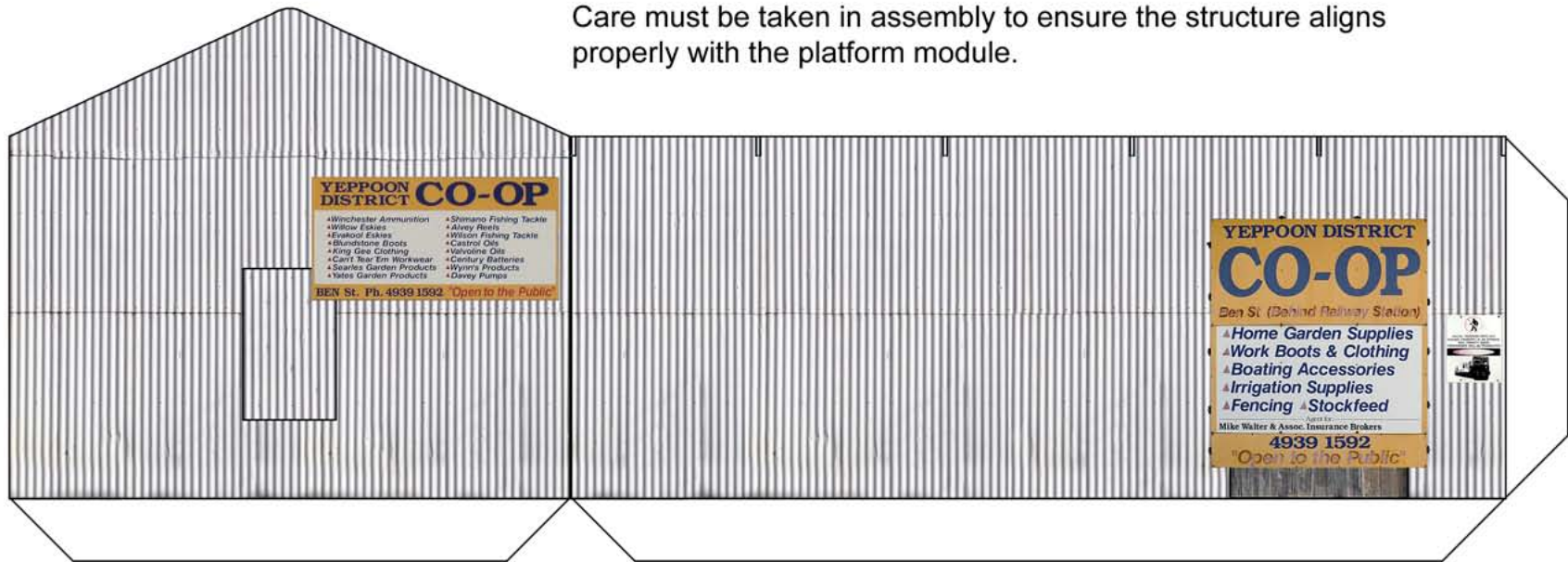

You may want to add small glue tabs to the top edges of the end walls to assist in mounting the roof.

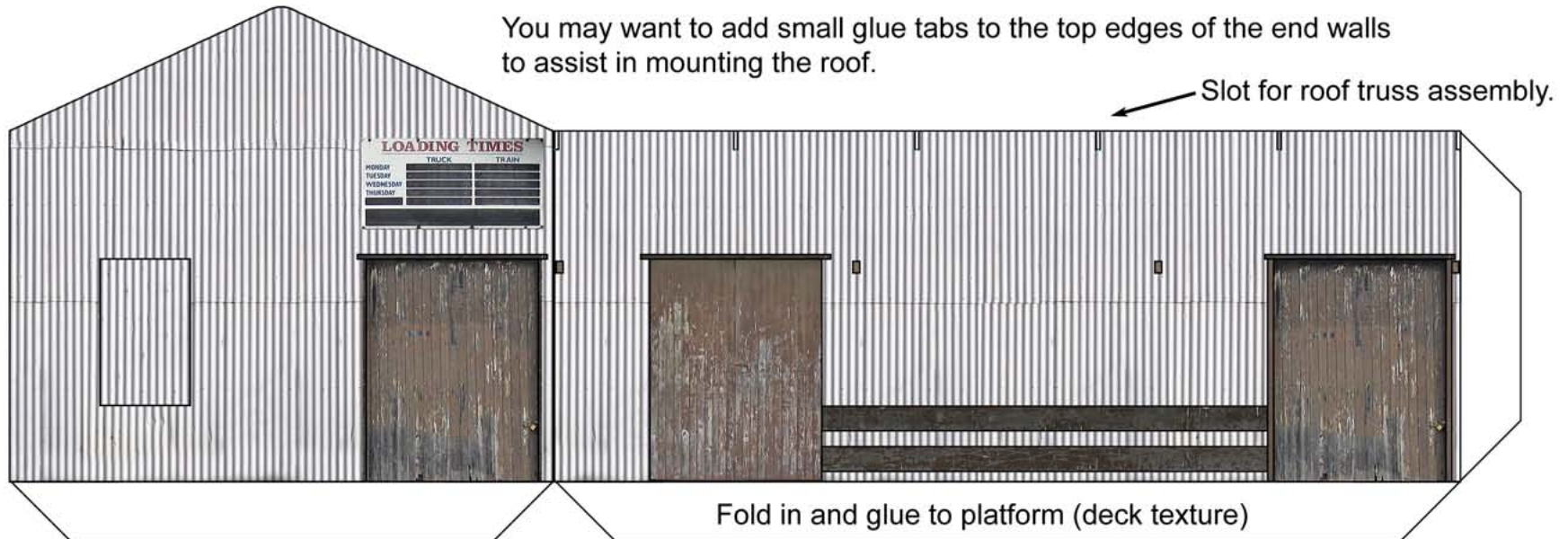



Assemble deck texture (above) first as a chocolate box lid, ensuring corners are square and edges vertical. Platform underside (stump base) folds and fits inside like box bottom, ensuring that it cannot be seen from side.

It may be useful to fit heavier card or timber strips to reinforce both deck and stump base before final gluing. Module must be firm enough to glue shed in place.

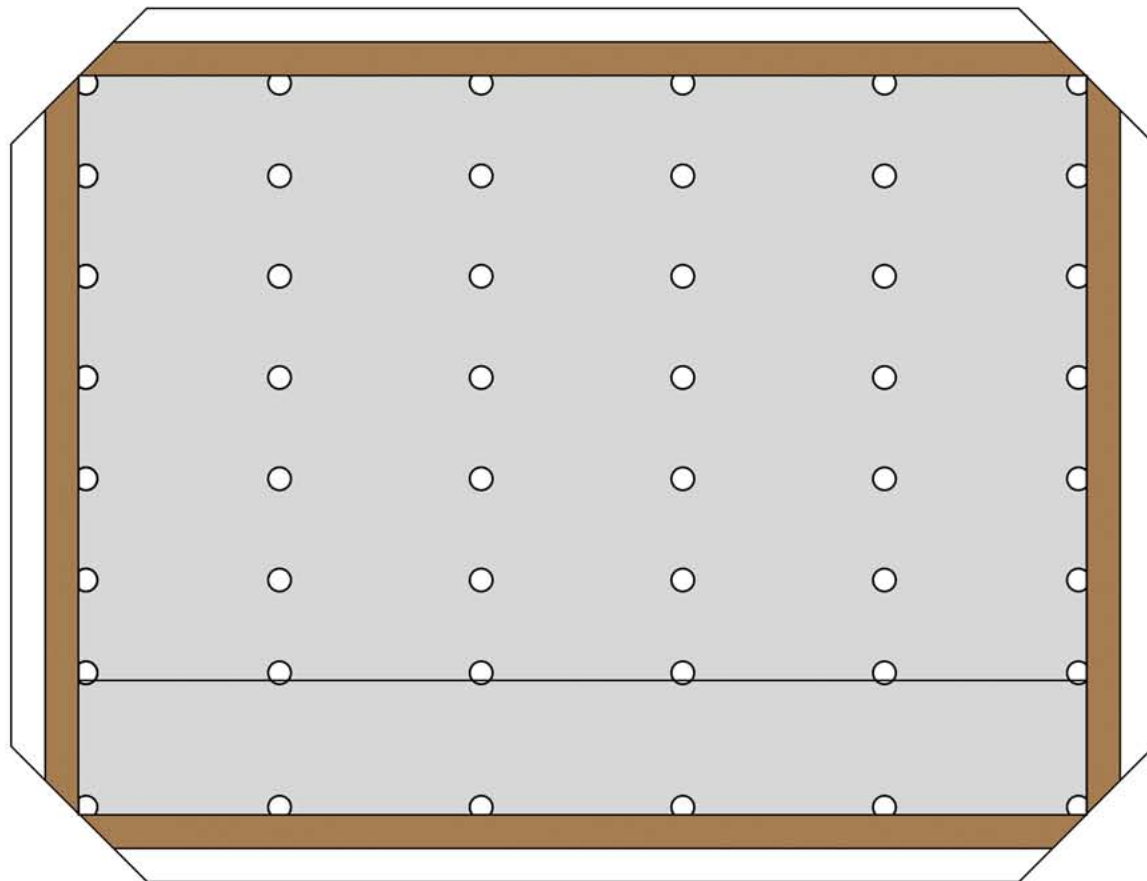

Platform underside shows stump locations (round, 8-10" dia). Depending on final location on layout it may only be necessary to fit stumps to outside edge positions and under steps (not shown).

The glue tabs on the stump base above must be folded twice at 90°: the tan coloured sides fit inside the platform face timbers (chocolate box top), while the white tabs fasten to the underside of the deck, making a closed box with the deck texture(s) effectively hiding the underside component.

Experimentation is required to ensure folds are straight, even AND narrow enough to hide the stump base inside the deck.

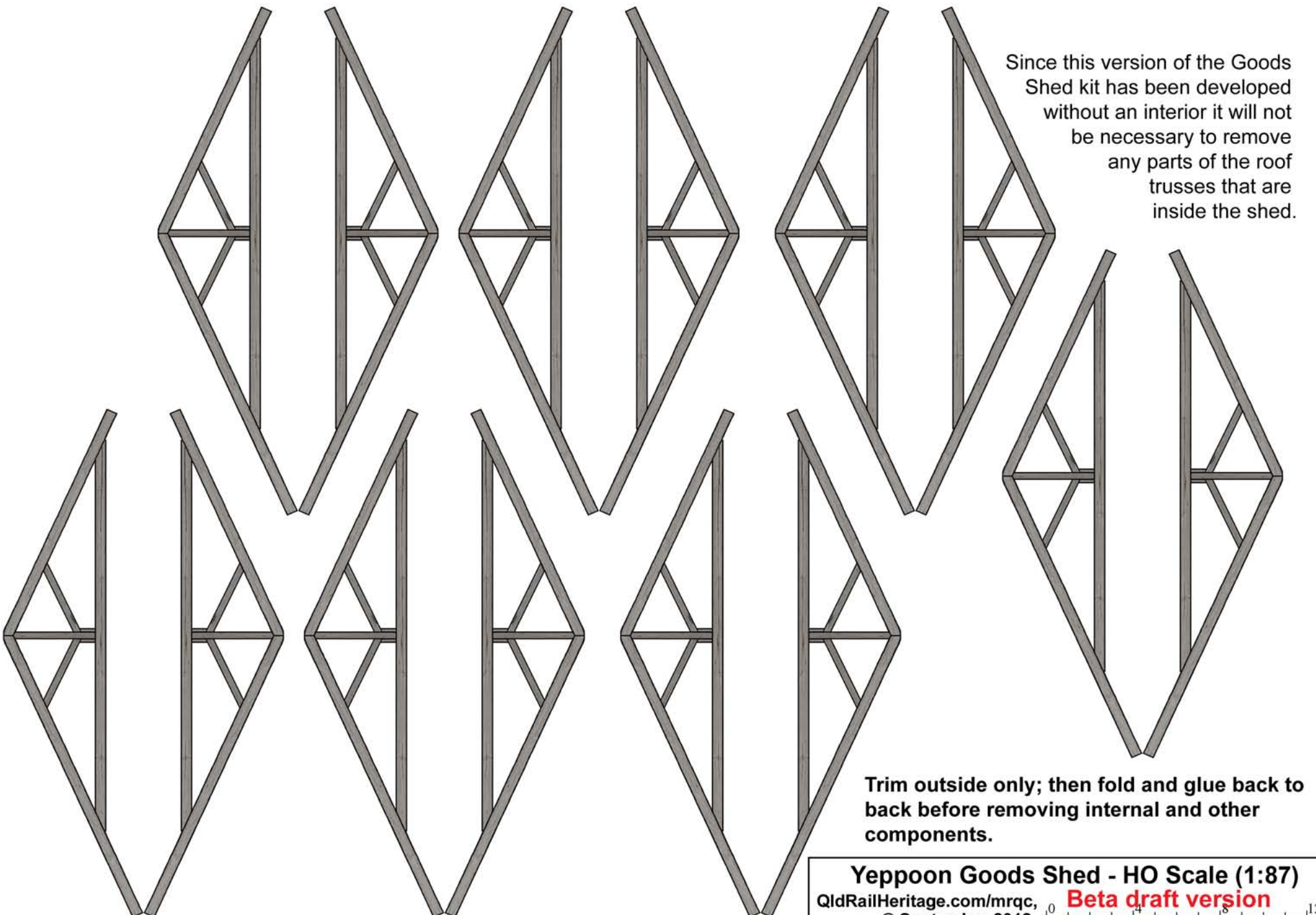

Since this version of the Goods Shed kit has been developed without an interior it will not be necessary to remove any parts of the roof trusses that are inside the shed.

Trim outside only; then fold and glue back to back before removing internal and other components.

Yeppoon Goods Shed - HO Scale (1:87)

QldRailHeritage.com/mrqc,
© September 2018

Beta draft version

0 4 8 12

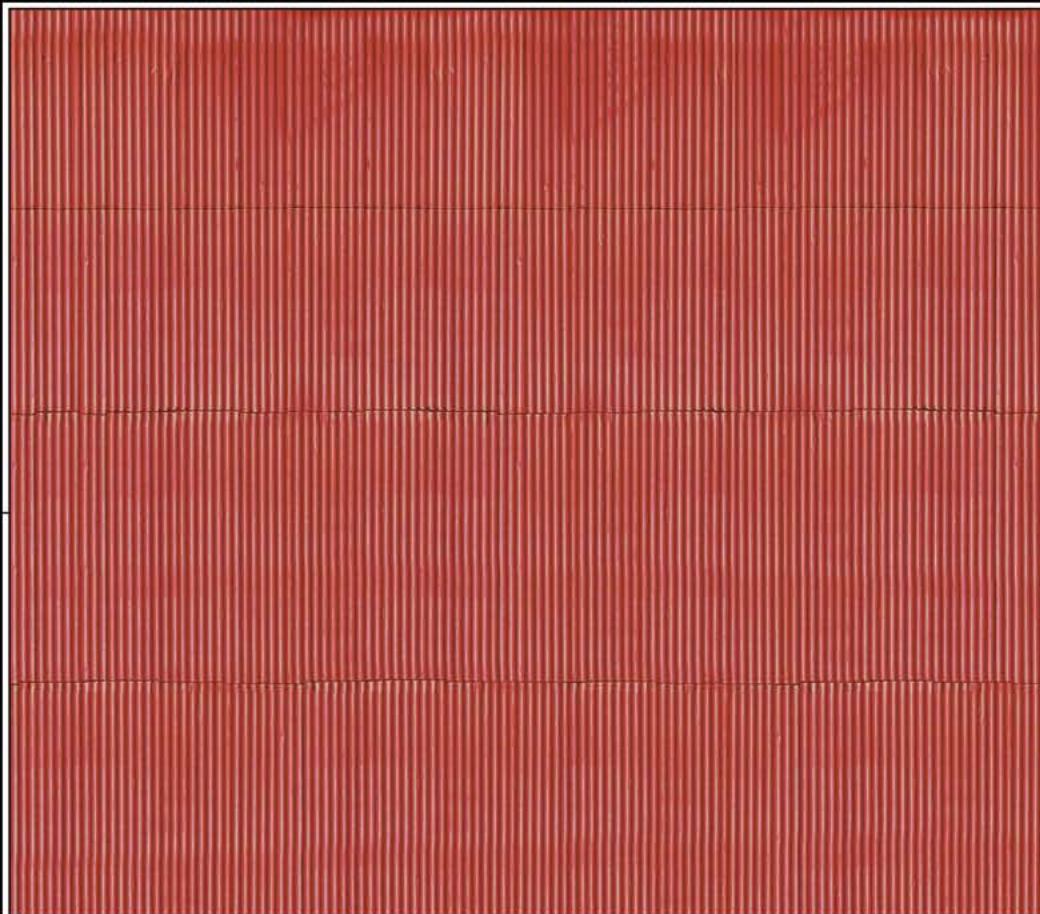

RL

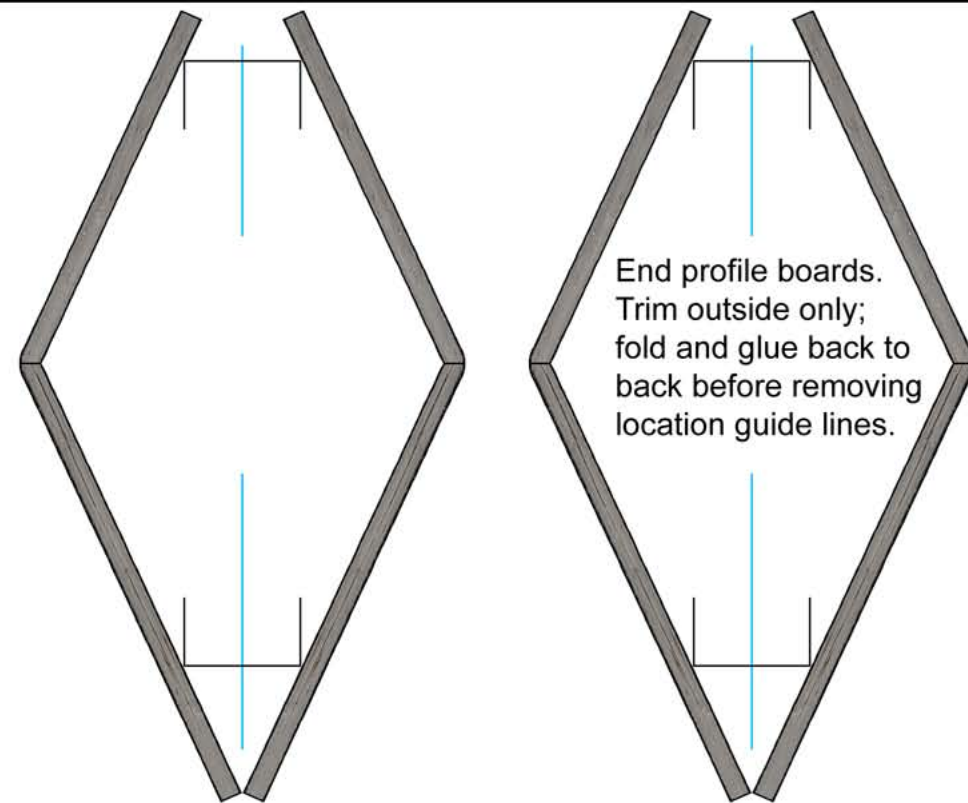

End profile boards.
Trim outside only;
fold and glue back to
back before removing
location guide lines.

CI roofing must be trimmed to fit. Note that roofing curves over roof truss at Ridge Line (RL, above), extends slightly beyond end of roof truss and ~12 scale inches beyond end of building. Battens should be cut slightly longer than shed length so end profile boards fit outside batten ends and tight to roofing CI.

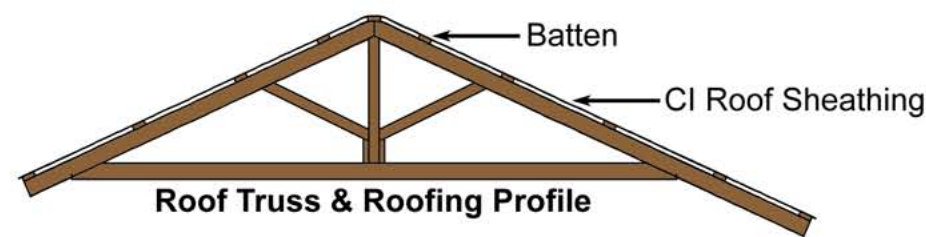

Roof Truss & Roofing Profile



Spare batten material can be glued back to back, cut 6 scale inches wide, and fitted as platform roof supports (see four required locations on shed wall near top of door level).

Batten material: Cut individual boards, then glue to underside of CI roofing, texture side facing down, using Roof Truss and Roofing Profile (right) as guide. Battens should extend 6 scale inches beyond building end to support end profile boards.





Pineapple boxes, pineapple being the major (only?) product shipped from the Yeppoon Station in later years.

- 1.5" vertical steel straps sides
- 1" x 2" timber vertical straps inside
- 1.5" d pipe, ends flattened across top
- 2" angle welded frame corners/ends
- 1" x 6" timber sides/floor
- 10" wide galvanised plates ends
- 2" x 3" timber skids/braces under box

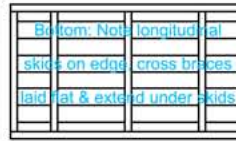
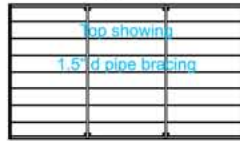
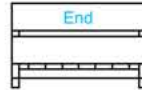

Use 2" x 3" scale lumber, stained appropriately, for cross braces (like joists) and skids under box.

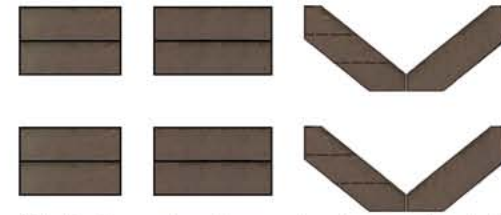
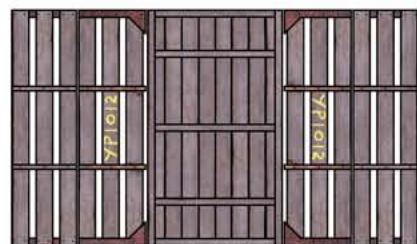
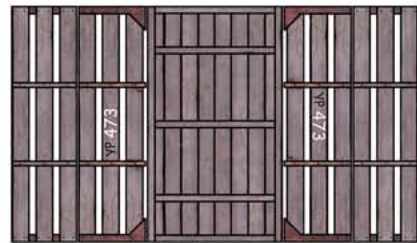

Stair treads: Two short required, fit between sides; bottom (longer) tread rests on stumps, with sides resting on it.

Stair sides: Dotted lines show tread placement, use narrow pieces of 2nd long tread as bracing under short treads.

Signs: Included to allow for 3D layering in subsequent kit iterations.

Credits: Thanks to John Armstrong, Capricorn Coast Historical Society, Doug Fardell and Arthur Hayes for background information. Goods Shed photos by Doug Fardell. Kit development and most photorealistic textures by Lynn Zelmer. Some textures may have been sourced from Clever Models plc or Textures.com.